

Basic 210

Some examples of applications:

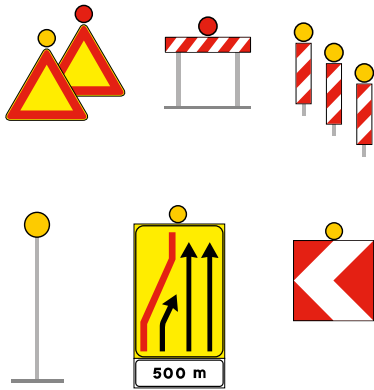

Adapter for Ø40 mm panels



Basic 210 is a LED warning light for temporary use. It is available in different models and it is suitable for all the applications where there is a need to warn, inform or guide road users.



Certification	EN12352 L8H - L8M
Input voltage	12/24 VDC
LED colour	● ● ●
Max. power consumption	6 W
Dimensions	Ø 210 x 85 mm

Flashing	Power cons. @12V	
Flash LED (10%)	1.2 Ah	/day
Tri Flash (5%+5%+5%)	1.8 Ah	/day
Single (50%)	6 Ah	/day
Steady	12 Ah	/day

Basic210

TECHNICAL FEATURES



Reference standards :

EN12352: L8H/L8M - P1 - C1 - R0 - A0 - V0 - I0 - F1/F2/F3 - O0/O1/O3 - M3 - T1 - S2
 EN50293 - EN60529 - EN60598-1 - 2011/65/UE - 2011/305/UE - 2012/19/UE - 2014/30/UE

OPTICAL CHARACTERISTICS

Light source	1 POWER LED	
Optics	Single-sided	
Color	Amber	
Duration of the optical group	> 50'000 hours	

ELECTRICAL CHARACTERISTICS

Supply	12/24 Vdc (11 Vdc ÷ 30 Vdc)	
Nominal power	6 W @ 12 Vdc	
Nominal current	500 mA @ 12 Vdc	
Protections	Reverse polarity; Overvoltages	

FLASHING

Frequency	Defined by External Command (steady light) or 45 flash/min (integrated flashing board) or 60 flash/min (integrated flashing board)	
Duty Cycle	Defined by External Command (steady light) or 50% (integrated flashing board) or 10% (integrated flashing board) or 5% + 5% + 5% (integrated flashing board)	

MECHANICAL CHARACTERISTICS

Operating temperature	- 25° C / + 55° C	
Lens material	Polycarbonate	
Body material	PA6	
IP protection class	IP65	
Weight	400 g	
Dimensions	Ø 210 mm x 85 mm	
Fixing	4 rear inserts for bracket attachment (not included)	
Wiring	Supplied with 2x0.75 mm ² cable	



Rev.2.2 30/06/2021		Approved TEC		Approved AQ
-----------------------	--	--------------	--	-------------

Basic 211

Some examples of applications:

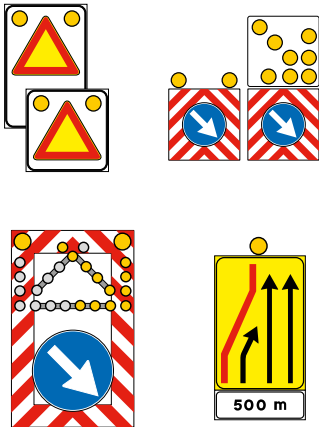

Basic 211 is the flat version of the Basic 210. It is available in different models and it is suitable for all the applications where there is a need to warn, inform or guide road users.

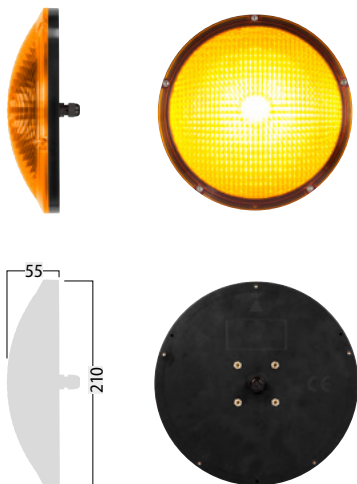

Certification	EN12352 L8H - L8M
Input voltage	12/24 VDC
LED colour	● ● ●
Max. power consumption	6 W
Dimensions	Ø 210 x 55 mm

Flashing	Power cons. @12V	
Flash LED (10%)	1.2 Ah	/day
Tri Flash (5%+5%+5%)	1.8 Ah	/day
Single (50%)	6 Ah	/day
Steady	12 Ah	/day

Basic211

TECHNICAL FEATURES



Reference standards :

EN12352: L8H/L8M - P1 - C1 - R0 - A0 - V0 - I0 - F1/F2/F3 - O0/O1/O3 - M3 - T1 - S2
 EN50293 - EN60529 - EN60598-1 - 2011/65/UE - 2011/305/UE - 2012/19/UE - 2014/30/UE

OPTICAL CHARACTERISTICS

Light source	1 POWER LED	
Optics	Single-sided	
Color	Amber	
Duration of the optical group	> 50'000 hours	

ELECTRICAL CHARACTERISTICS

Supply	12/24 Vdc (11 Vdc ÷ 30 Vdc)	
Nominal power	6 W @ 12 Vdc	
Nominal current	500 mA @ 12 Vdc	
Protections	Reverse polarity; Overvoltages	

FLASHING

Frequency	Defined by External Command (steady light) or 45 flash/min (integrated flashing board) or 60 flash/min (integrated flashing board)	
Duty Cycle	Defined by External Command (steady light) or 50% (integrated flashing board) or 10% (integrated flashing board) or 5% + 5% + 5% (integrated flashing board)	

MECHANICAL CHARACTERISTICS

Operating temperature	- 25° C / + 55° C	
Lens material	Polycarbonate	
Body material	PA6	
IP protection class	IP65	
Weight	350 g	
Dimensions	Ø 210 mm x 55 mm	
Fixing	4 rear inserts for bracket attachment (not included)	
Wiring	Supplied with 2x0.75 mm² cable	



Rev.2.2 30/06/2021	Approved TEC	Approved AQ
-----------------------	--------------	-------------

Basic 308

Some examples of applications:

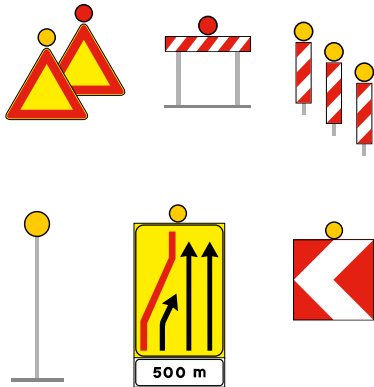

Adapter for Ø40 mm panels

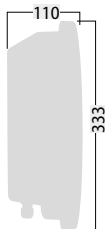

Basic 308 is a LED warning light for temporary use. The high luminous efficiency, the uniformity and the wide visual angles, make this product the best in its category.

Compliance	EN12352 L9M
Input voltage	12 VDC - 12/24 VDC
LED colour	● ●
Max. power consumption	17.5 w
Dimensions	Ø 333 x 110 mm

Flashing	Consumi @12V	
Flash LED (10%)	3.0 Ah	/day
Tri Flash (5%+5%+5%)	4.5 Ah	/day
Single (50%)	15 Ah	/day
Steady	30 Ah	/day

Basic308

TECHNICAL FEATURES



Reference standards :

EN12352: L9M - P1 - C1 - R0 - A0 - V0 - I0 - F1/F2/F3 - O0/O1/O3 - M3 - T1 - S2
 EN50293 - EN60529 - EN60598-1 - 2011/65/UE - 2011/305/UE - 2012/19/UE - 2014/30/UE

OPTICAL CHARACTERISTICS

Light source	85 LEDs	
Optics	Single-sided	
Color	Amber	
Duration of the optical group	> 50'000 hours	

ELECTRICAL CHARACTERISTICS

Supply	12/24 Vdc (11 Vdc ÷ 30 Vdc)	
Nominal power	17.5 W @ 12 Vdc	
Nominal current	1.5 A @ 12 Vdc	
Protections	Reverse polarity; Overvoltages	

FLASHING

Frequency	Defined by External Command (steady light) <i>or</i> 45 flash/min (integrated flashing board) <i>or</i> 60 flash/min (integrated flashing board)	
Duty Cycle	Defined by External Command (steady light) <i>or</i> 50% (integrated flashing board) <i>or</i> 10% (integrated flashing board) <i>or</i> 5% + 5% + 5% (integrated flashing board)	

MECHANICAL CHARACTERISTICS

Operating temperature	- 25° C / + 55° C	
Lens material	Polycarbonate	
Body material	PA6	
IP protection class	IP65	
Weight	1.9 kg	
Dimensions	Ø 333 mm x 110 mm	
Fixing	Bracket for 60 mm poles	
Wiring	Supplied with 1.5 m long 2x0.75 mm ² cable	

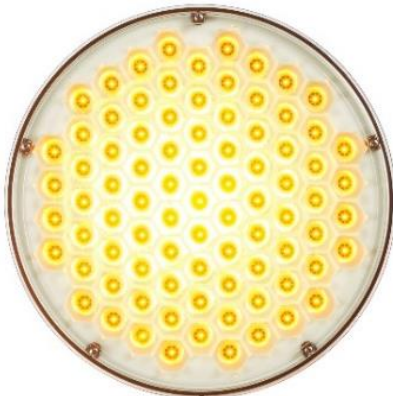

Rev.2.1
16/11/2020

Approved TEC

Approved AQ

Basic 309

Some examples of applications:

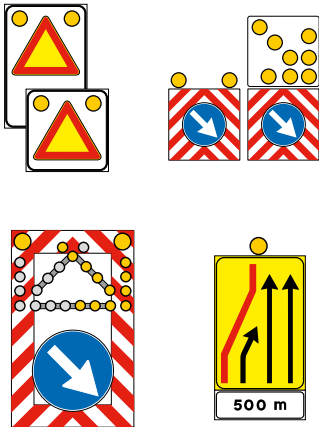

Basic 309 is the flat version of the Basic 308.
The high luminous efficiency, the uniformity and the wide visual angles, make this product the best in its category.



Compliance	EN12352 L9M
Input voltage	12 VDC - 12/24 VDC
LED colour	● ●
Max. power consumption	17.5 W
Dimensions	Ø 333 x 64 mm

Flashing	Consumi @12V	
Flash LED (10%)	3.0 Ah	/day
Tri Flash (5%+5%+5%)	4.5 Ah	/day
Singole (50%)	15 Ah	/day
Steady	30 Ah	/day

Basic309

TECHNICAL FEATURES



Reference standards :

EN12352: L9M - P1 - C1 - R0 - A0 - V0 - I0 - F1/F2/F3 - O0/O1/O3 - M3 - T1 - S2
 EN50293 - EN60529 - EN60598-1 - 2011/65/UE - 2011/305/UE - 2012/19/UE - 2014/30/UE

OPTICAL CHARACTERISTICS

Light source	85 LEDs	
Optics	Single-sided	
Color	Amber	
Duration of the optical group	> 50'000 hours	

ELECTRICAL CHARACTERISTICS

Supply	12/24 Vdc (11 Vdc ÷ 30 Vdc)	
Nominal power	17.5 W @ 12 Vdc	
Nominal current	1.5 A @ 12 Vdc	
Protections	Reverse polarity; Overvoltages	

FLASHING

Frequency	Defined by External Command (steady light) <i>or</i> 45 flash/min (integrated flashing board) <i>or</i> 60 flash/min (integrated flashing board)	
Duty Cycle	Defined by External Command (steady light) <i>or</i> 50% (integrated flashing board) <i>or</i> 10% (integrated flashing board) <i>or</i> 5% + 5% + 5% (integrated flashing board)	

MECHANICAL CHARACTERISTICS

Operating temperature	- 25° C / + 55° C	
Lens material	Polycarbonate	
Body material	PA6	
IP protection class	IP65	
Weight	1.9 kg	
Dimensions	Ø 333 mm x 64 mm	
Fixing	4 rear inserts for bracket attachment (not included)	
Wiring	Supplied with 1.5 m long 2x0.75 mm ² cable	

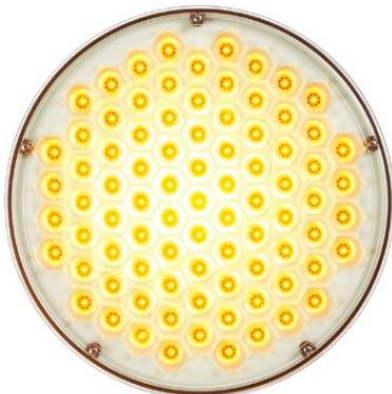

Rev.2.1
16/11/2020

Approved TEC

Approved AQ